

ADMIN USER MANUAL
OF
Famous Android Application
Version 1.0.1



Available on:



DEVELOPED BY:
AKS SOFTWARE LIMITED
SECTOR 63, NOIDA
PIN- 201301

TABLE OF CONTENTS

1 INTRODUCTION.....	1
2 LOGIN SCREEN.....	2
3 ADMIN DASHBOARD.....	3
4 MANAGE CONFIGURATION.....	4
5 MANAGE USER.....	5
6 ADD NEW USER.....	6
7 USER INFORMATION.....	7
7 UDATE USER INFORMATION.....	8
8 ASSIGN RIGHTS TO USER.....	9
9 PLOT INFORMATION.....	10
9.1 GET PLOT INFORMATION.....	10
9.2 SHOW PLOT INFORMATION.....	11
10 CHANGE PASSWORD.....	12
11 RECOVERY VALUES.....	13
12 NAVIGATION.....	14

INTRODUCTION

Famous App is an unique initiative of AKS for sugarcane factories. This mobile app provides up-to-date information about following using his mobile phone. The data is retrieved directly from sugar factory's server in real time:

- Purchase
- Receipt
- Daily crushing
- Payments
- Supply Tickets
- Loan
- Surveyed Area
- Sugarcane Inventories

LOGIN SCREEN

Admin login- Provided by Factory owner/AKS team

Password- Provided by Factory Admin or AKS team

Login- Go with login using correct user-id and password

Unable to login- Call us directly

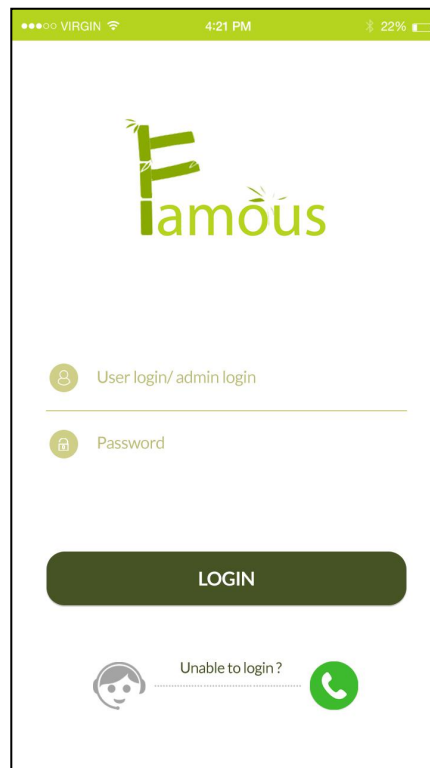

ADMIN DASHBOARD

Manage Configuration- Configuration management is the detailed recording and updating of information that describes an enterprise's hardware and software.

Manage User- Admin will be able to create, edit or delete users from within factory and assign users to project roles.

Recovery Values- Only Admin have the rights to enter recovery values. Same values will reflect on daily crushing tab on user dashboard.

Role Switcher- Admin default have the rights same as user. Admin switch between admin to user role anytime. No need to login as user to check the report.

Navigation- For quick access

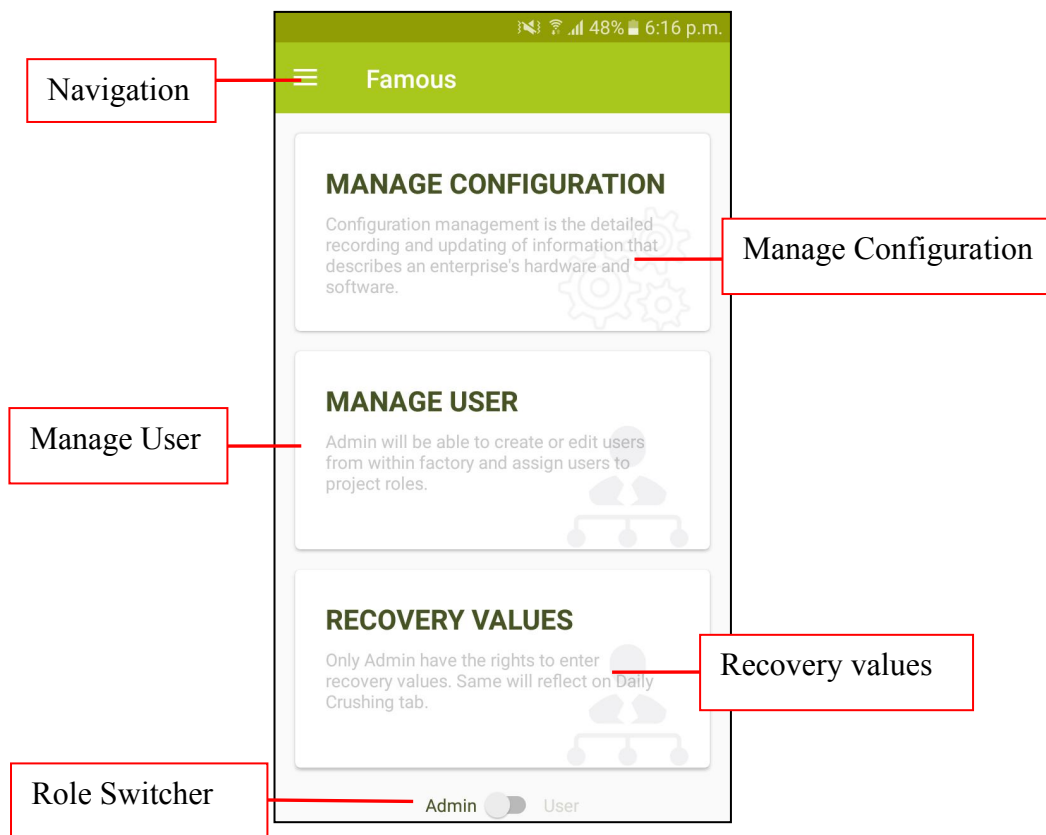

MANAGE CONFIGURATION

Fill your database information and establish a connection to show the factory information.

Supported databases:

1. SQL
2. Oracle

Note: All your information is secure with us. This is one time exercise only.

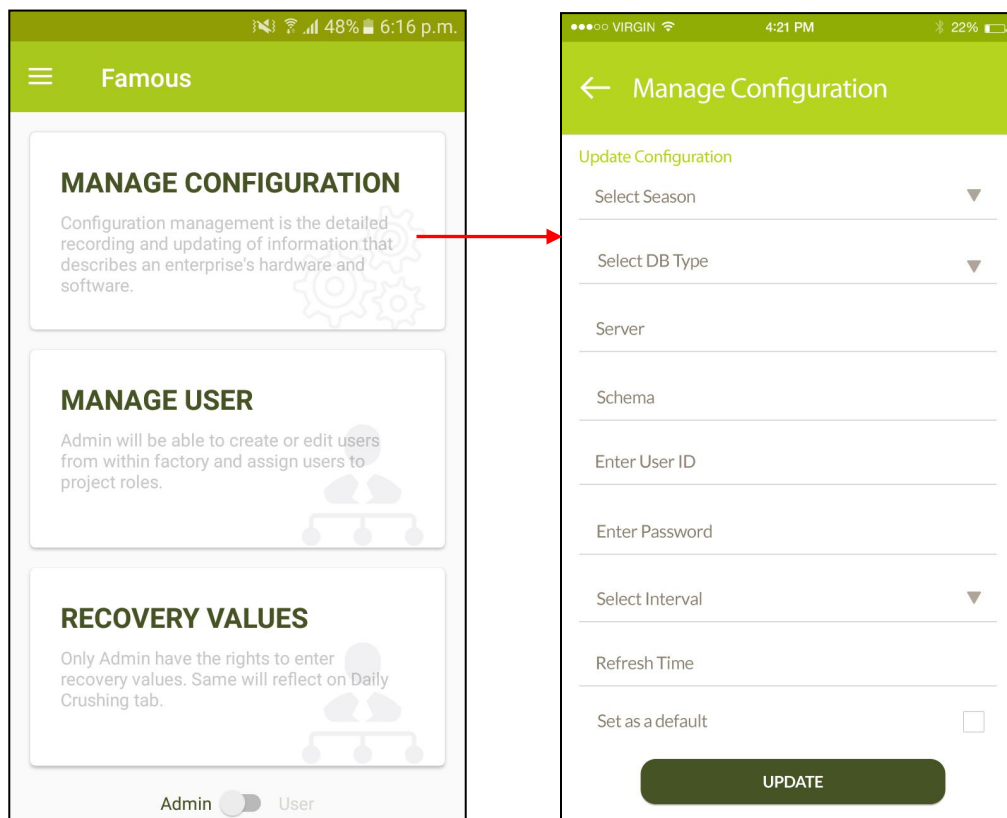

MANAGE USER

User List- Admin can view all added users

Add User- Add new user in factory

User information- Click on individual user for more detail about user

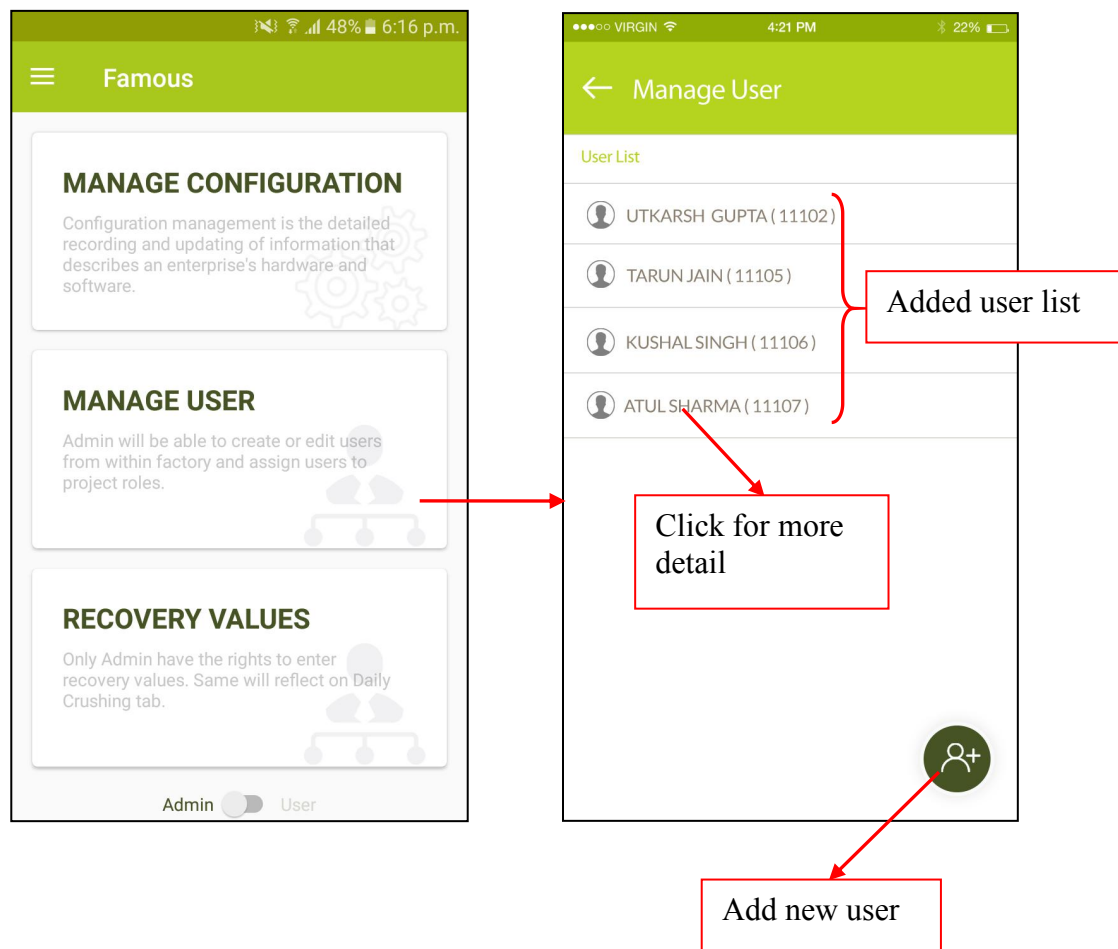

ADD NEW USER

User Detail- Fill user name, department & mobile number

Validation- Select date for user validity.

Active- click on check box to active user

ADD User- Click on ADD button for adding

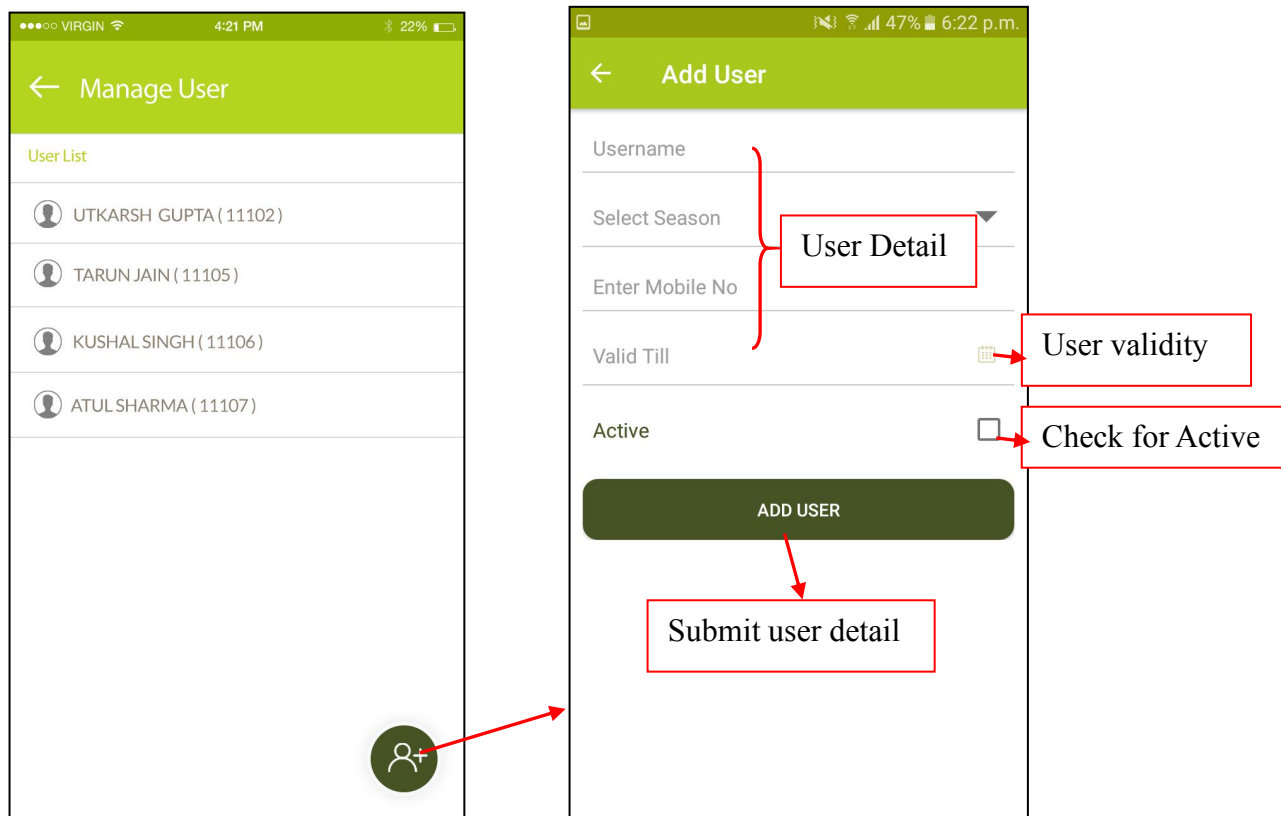

USER INFORMATION

Update user information- update user information and save

Reset user password- Reset user password and share with user

Assign rights to user- Assign rights to user to view the user dashboard

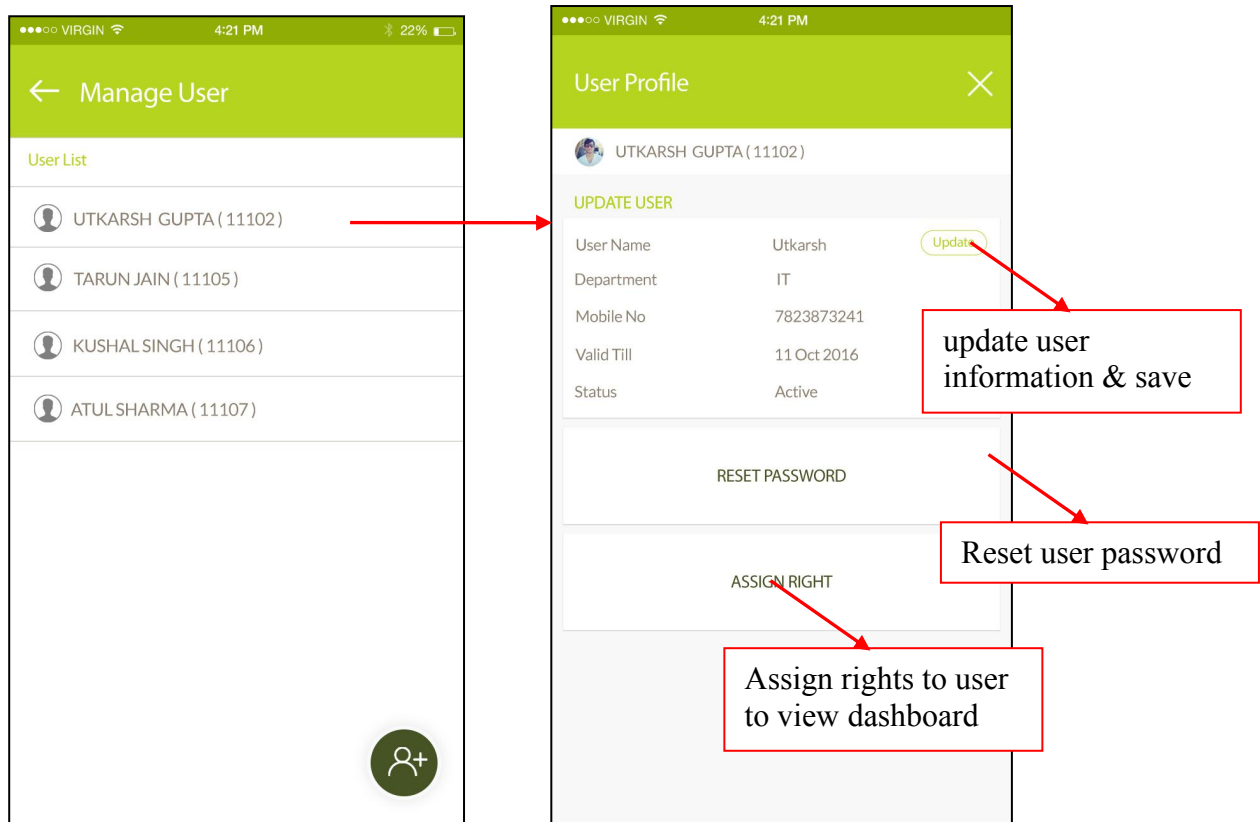

UPDATE USER INFORMATION

Admin can change all user information and change the validity and status as well.

User detail- Name, Department, mobile number

User rights- Validity & Status(Active/D-active)

Ok- Save the new information

Cancel- Exit without saving user information

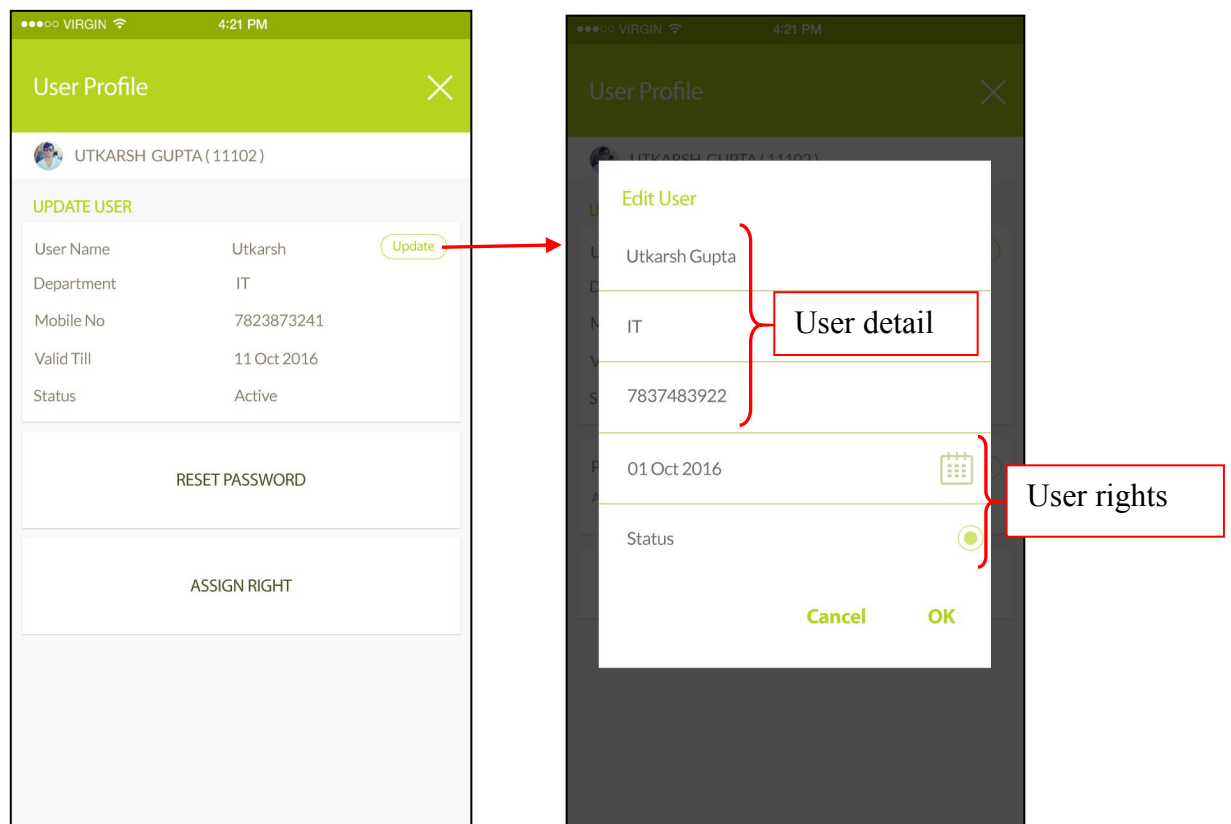

ASSIGN RIGHTS TO USER

Select Tab- Select tab from “Select order list”. Selected tabs will appear on Assign rights.

Remove tab- Admin can remove selected tabs from “Assign rights”.

Change tab order- if Admin wants to change the tabs order than need to hold the tab and rearrange.

Note: Tab order will show as per the selected order.

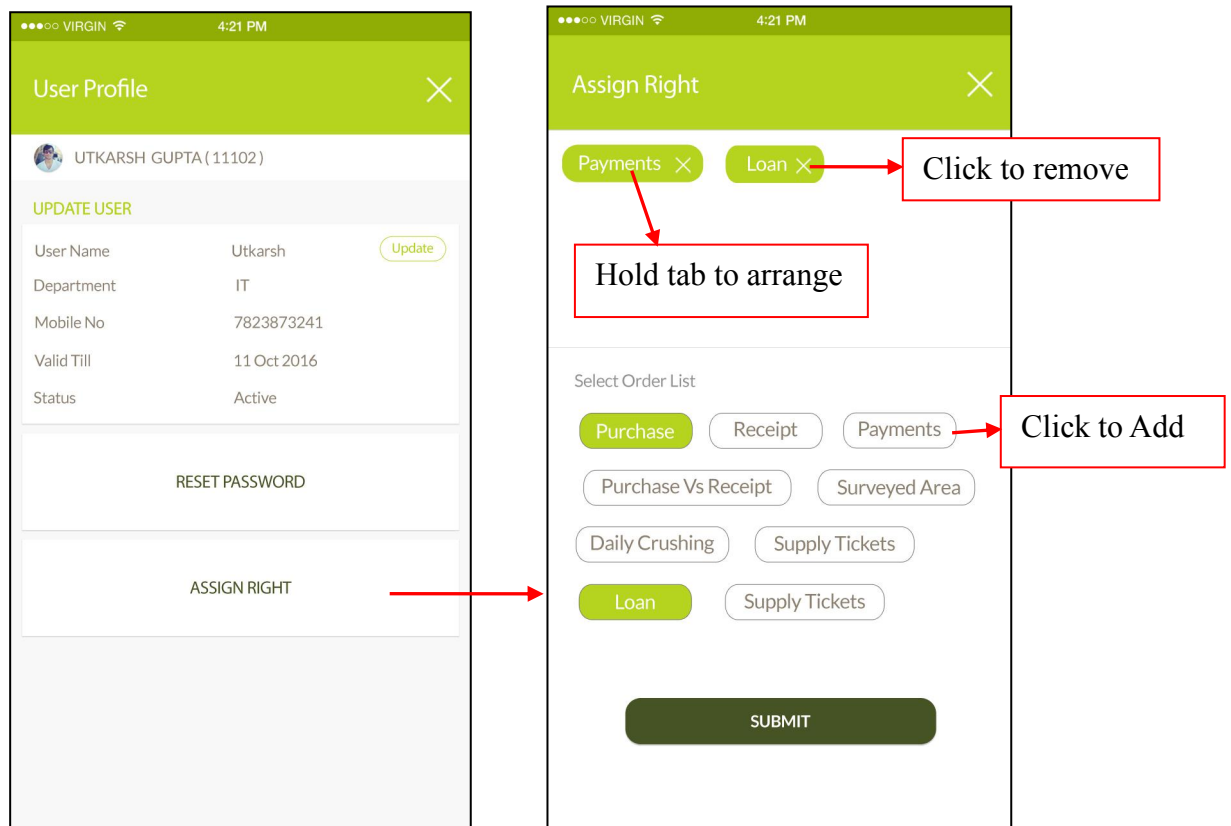

GET PLOT INFORMATION

Select Village- Once user click on Select village than a drop-down list will appear. User need to select the village to know the plot information.

Latitude/Longitude- Those are the values coming by Google API. Its indicate the current user position.

Search- User need to click on “Search” button to know the selected village plot information.

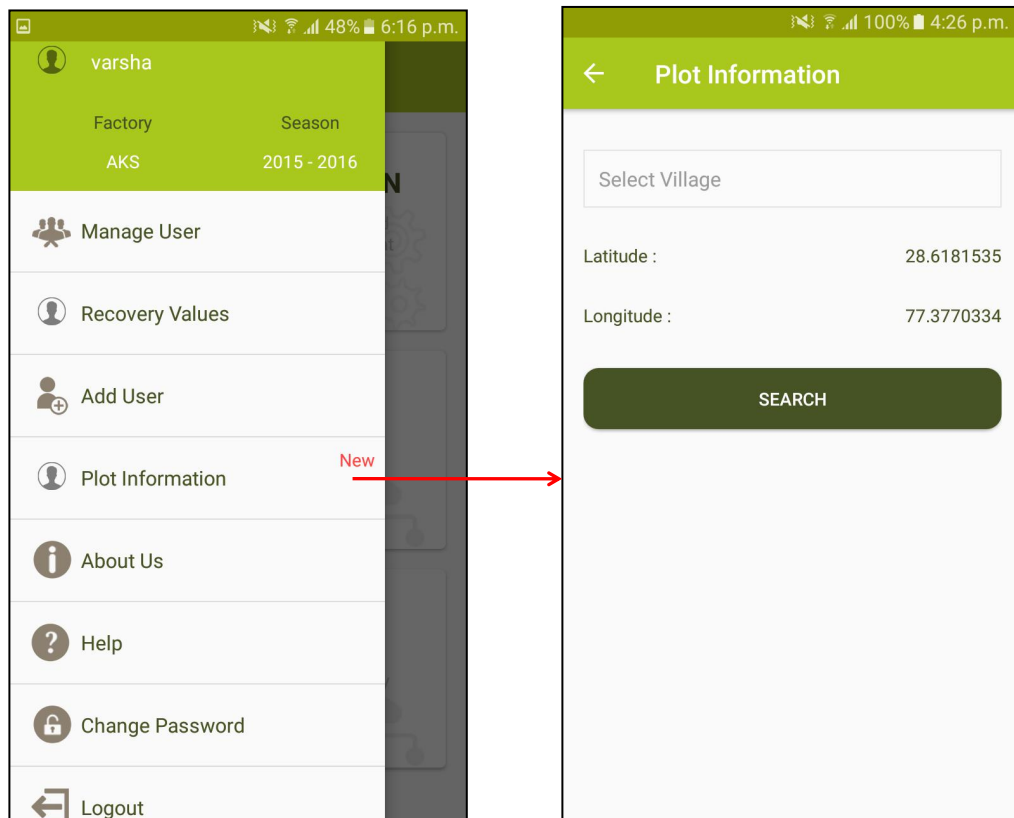

SHOW PLOT INFORMATION

Plot Information

Select Village

Latitude : 28.6181535

Longitude : 77.3770334

SEARCH

Know Plot information

Select Villages

Latitude 20.5137° N

Longitude 78.1629° E

Search Plot

SEARCH

Plot information

Plot Village :	Singhpur
Grower Village :	Singhpur
Grower Name	Ramdas Singh
Grower Father Name :	Motilal Singh
Phone No	+91 7834623221
Area	Ranikhet

NAVIGATION

Navigation bar have shortcuts to access mobile app functionality.

